

Research Record

RuiQin 24001018

2024/2025

Self-record form 2024 - 2025.

U1

2/10/2024

Surprise yourself

Re-do things to improve them

A great idea is rarely in the first draft

4/10

Principles: An idea is a new combination of old ideas based on an ability to see relationships

- Process: An operative technique that can be developed and used like any tool based on a constant preoccupation with the possibilities of new combinations

A literature review examines published scholarly articles, papers, books, reports and other relevant sources that provide an informed description, summary or critical account related to a particular design issue or area of exploration.

FORM

[1] Chronologically

[2] Perspective /schools of thought

[3] Research methods

[4] Topics/themes: (most common for an essay)

First, during the site selection stage, when I was wandering around the school, I found a colorful place - Peckham Theatre! Its outer wall is made of glass, and I can see directly inside. This makes me feel safe. It's amazing that I have this feeling, but I do feel this way. (Maybe it's because of the transparency) The decoration inside is colorful and bright. There are high and low color blocks on the walls of the hall, and colorful thin lines are hung on the ceiling, which makes me feel relaxed and lively. So I chose this place as my research space.

Then I did a survey of the shape distribution, color distribution and movement lines of the space. It was very interesting. Each end of the lines hanging from the ceiling had some cards or photos

hanging on it. They were all about drama clips and people and things in the past. There were glowing colored tubes on the wall. When the light hit the glass, there would be some weak reflections. So when I first entered, I also found colorful lines on the glass.

MODEL STEP 模型阶段:

I made a model.

At first, I planned to make a luminous space (refer to Model 1 in the portfolio), but then I found that I couldn't cut the sides of this metal cookie box, it was too hard (I wanted irregular edges). So I could only frame it with a square box.

But after finishing it, I found that the materials used were tin foil and can fragments, and their reflectivity was not high enough. So it was difficult for the light to be reflected strongly. I could only reduce the ambient light to a minimum, and only in the dark could I see the faint reflected light.

So I planned Model 2 - Drift Bottle Plan. (For the theme content, refer to the introduction of Model Plan 2 in the portfolio) This model was quite successful, and it looked very similar to my design. But unfortunately, because the color of the thin iron wire was lighter, the color of the line was not very obvious.

Since there were still some scraps left from my collection, I decided to use them all up. The theme of the final project was based on an animation I watched recently, "Allegory of the Crypt". It is a story in "The Republic" written by Plato. It's quite philosophical, so I wondered if it was possible to make a small model with the same philosophy? So I tried to combine the effects of mountains and light and shadow, and the final product was Model 3 in portfolio.



地穴寓言 Allegory of the Crypt 理想国

https://youtu.be/tk_UPRd8lxM?si=IV3lpW95tCmlHOoC

空间的概念是因人而异的

SITE 影子小圈:

I found this small window above the lecture hall on the first floor, through which light projects a circular area.

Some students made movements with the shadow of their hands in the light. When the light changes position over time, other students will also make the same movements towards this small circle.

This inspired me, and I wondered if this means that the small circle = relatively static space. Then these movements are stored in this space and then iterated.

In this case, if I make a movement towards the small circle at 11 a.m., I am actually doing the same thing as the students who also make a movement towards the small circle at 1 p.m. (in the space of the small circle)

I found some theoretical explanations

Reference: Einstein's Theory of Relativity

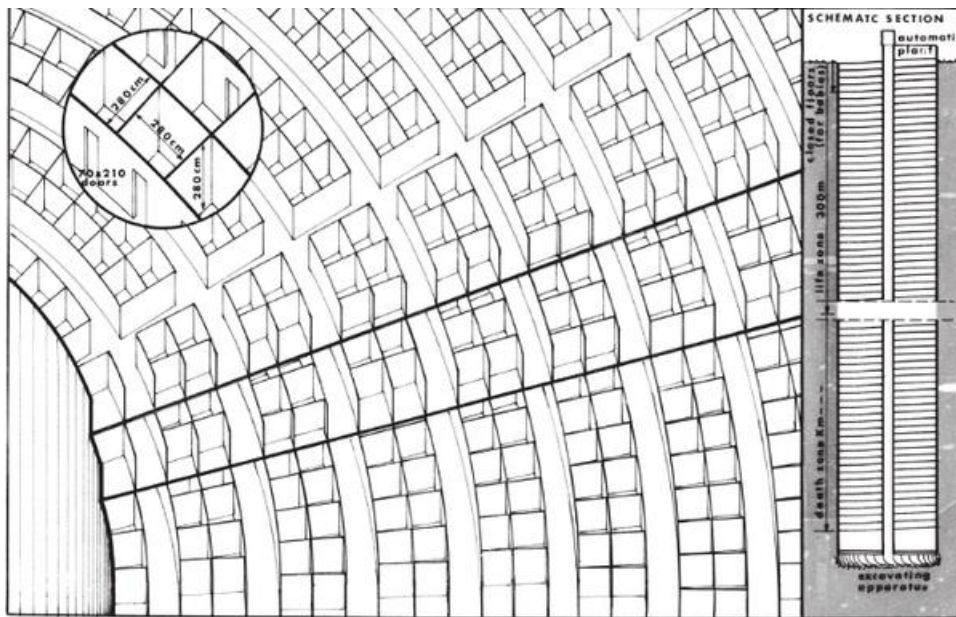

时间螺旋之城 Temporal cochlea-city

<https://socks-studio.com/2011/09/17/twelve-cautionary-tales-for-christmas-12-ideal-cities-by-superstudio-1971/>

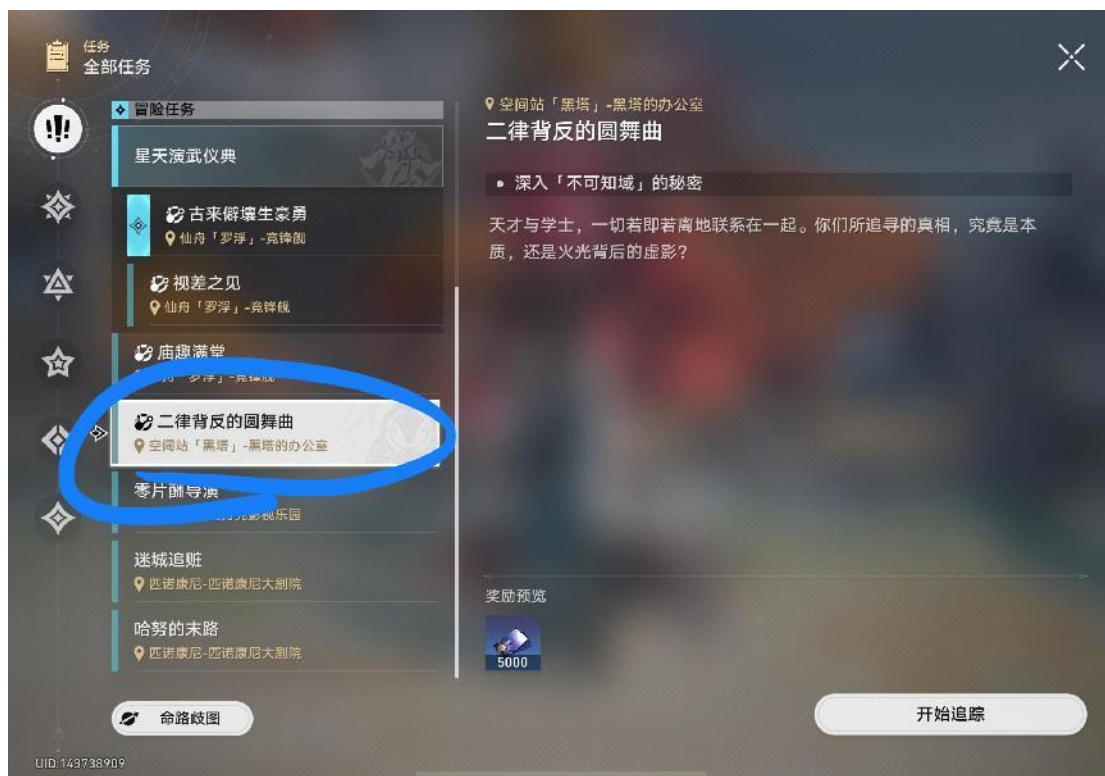

二律背反? 星穹铁道游戏任务 Antinomy? Star Railway game mission

What is Antinomy?

二律背反（是一种哲学概念。意指对同一个对象或问题所形成的两种理论或学

说虽然各自成立但却相互矛盾的现象，又译作二律背驰，相互冲突或自相矛盾。

二律背反受伊曼努尔·康德 IMMANUEL KANT 在其代表作《纯粹理性批判》中推广。在书中，康德列出四种二律背反，均由正题和反题组成。康德先设置了理性作为感性与知性的综合。知性所依赖的范畴是先验的，由量、质、关系、样式等十二个范畴组成。当理性试图使用这些范畴去规范先验的无限物时，就会出现范畴失效的情况，也就是二律背反。四组二律背反被康德分为两类，四项正命题被称为柏拉图线。四项反命题被称为伊壁鸠鲁线。

Antinomy (is a philosophical concept. It refers to the phenomenon that two theories or doctrines formed on the same object or problem are contradictory although they are valid. It is also translated as antinomy, conflict or self-contradiction. Antinomy was popularized by Immanuel Kant in his masterpiece "Critique of Pure Reason". In the book, Kant listed four antinomies, each consisting of a thesis and an antithesis. Kant first set up reason as a synthesis of sensibility and intellect. The categories that intellect relies on are a priori, consisting of twelve categories such as quantity, quality, relationship, and style. When reason tries to use these categories to regulate a priori infinite things, the categories will fail, which is an antinomy. The four groups of antinomies are divided into two categories by Kant. The four propositions are called the Platonic line. The four antitheses are called the Epicurean line.

伊曼努尔·康德

星云假说 ? ? ? ? ? ?

<https://zh.wikipedia.org/wiki/%E6%98%9F%E9%9B%B2%E5%81%87%E8%AA%AA>

After making the model, I changed my direction. I was originally attracted by the color distribution of the theater, but as the research deepened, I found that I was more curious about the transmission of space-time information. The reason is that there are cards or photos at each end of the wires hanging from the ceiling of the theater, so when I looked at them one by one, I suddenly felt that this seemed to be information exchange across time and space.

Because when I was an undergraduate, I had a project about Alzheimer's disease, and my relative's grandmother suffered from this disease. She always said the past words to the people of the present in reality, and lived in the information of the past. So when I read these cards, I was also briefly talking to the past. So grandma = always looking at these cards. So the card = stage, grandma = audience, there must be something wrong with the space between them, which caused grandma to always see the zero-one play on the stage.

So I changed my direction, and it was better to find a research point in depth than to change it.

Some theoretical reference charts and inspiration in related fields

Virtual space

The characteristic is that the space scope is not clear, the privacy is small, and it is in the physical space. Also known as a space within a space or "mental space"

An understanding of *space wherein the relative location

Furth wall

Theory of drama

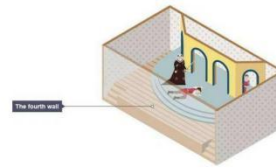

Relative existence space

An understanding of space wherein the relative location of bodies is determined with respect to other bodies. Relative space contrasts with absolute space, wherein location is understood with respect to an independent frame of reference such as a coordinate system. The dimensions of absolute space are fixed and immovable, whereas relative space is a movable dimension.

Picture form my PPT.

分镜 Video storyboard:

I made some schematic diagrams of the points I found in the research. Combined with some theories. This makes it easier for me to understand. (Otherwise I would easily get lost) Then at the sharing session, I looked at other students' works.

1. A classmate made something similar to a light box. She also studies stage. I talked to her. She was a photography major before, so she was studying light and shadow. Mainly similar to shadow puppetry. It gave me a lot of inspiration.

2. I asked the professor some questions, and the professor said that I should think more specifically about how to express this space and do more thinking in this regard.

3. After I went home, I reflected that indeed, the space expression is still more theoretical. So how should my own design space be presented?

导师组讨论 Tutor Group Discussion:

I am very happy to be assigned to this group. The professor gave me very useful suggestions. Because I am studying this transparent space between the audience and the stage. As an international student, there is a natural gap. Especially when I watch a play, the actors speak too fast to understand what is happening. But even so, I still enjoy the process of the stage performance. There is no tension or boredom in the space.

This is very different from Chinese drama. They are both thousands of years of culture, thousands of years of drama performances, and the performance language is incomprehensible. Why do young people prefer Western drama? This fourth space between the stage story and the audience may give some clues.

I bought pantomime tickets for Christmas and watched Robin Hood and another small pantomime.

Personal experience:

I summarized a few points, abbreviated them briefly, and put them in the paper. (Refer to U1CRP PART3-4)



Space design:

At present, it has been determined that the fourth space design is based on the individual. The physical model is used as the carrier. I have seen many artists (Nakajima Fujiko, Fog Stage), some of whom set up the stage behind the cloth. It is to clarify the edges.

I currently have a few sketches, and then continue to modify them.

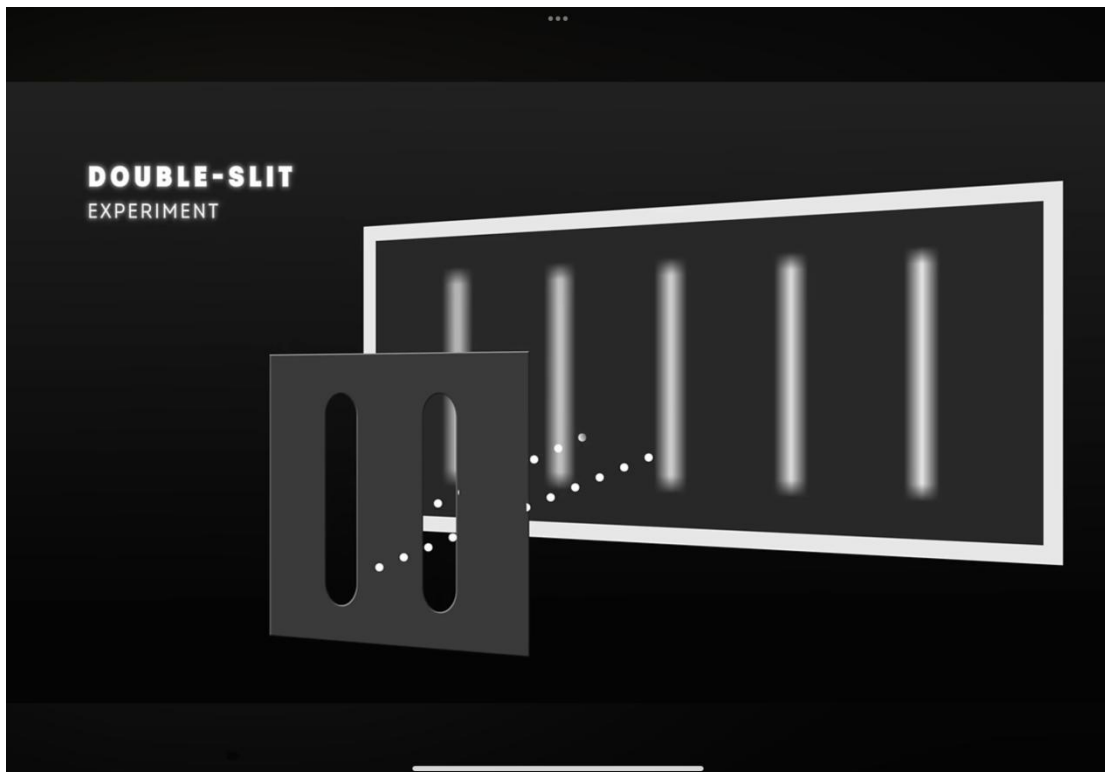
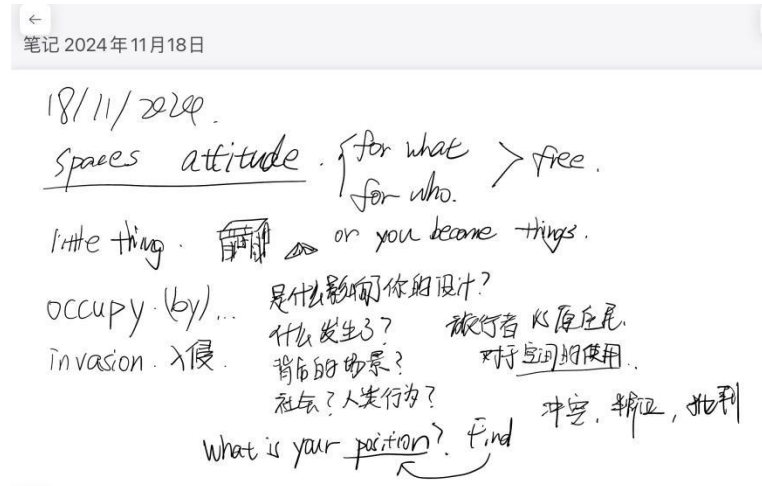

时间和空间的一些解释 Some explanations of time and space

<https://youtu.be/zrDtRbFPnRw?si=ByLMvw934AjDzXz>



我回到过去和我爸一起坐火车 I went back in time and took the train with my dad
https://youtu.be/A_1vf0UfXuW?si=xZJ-7Kvm8g8sz6TL

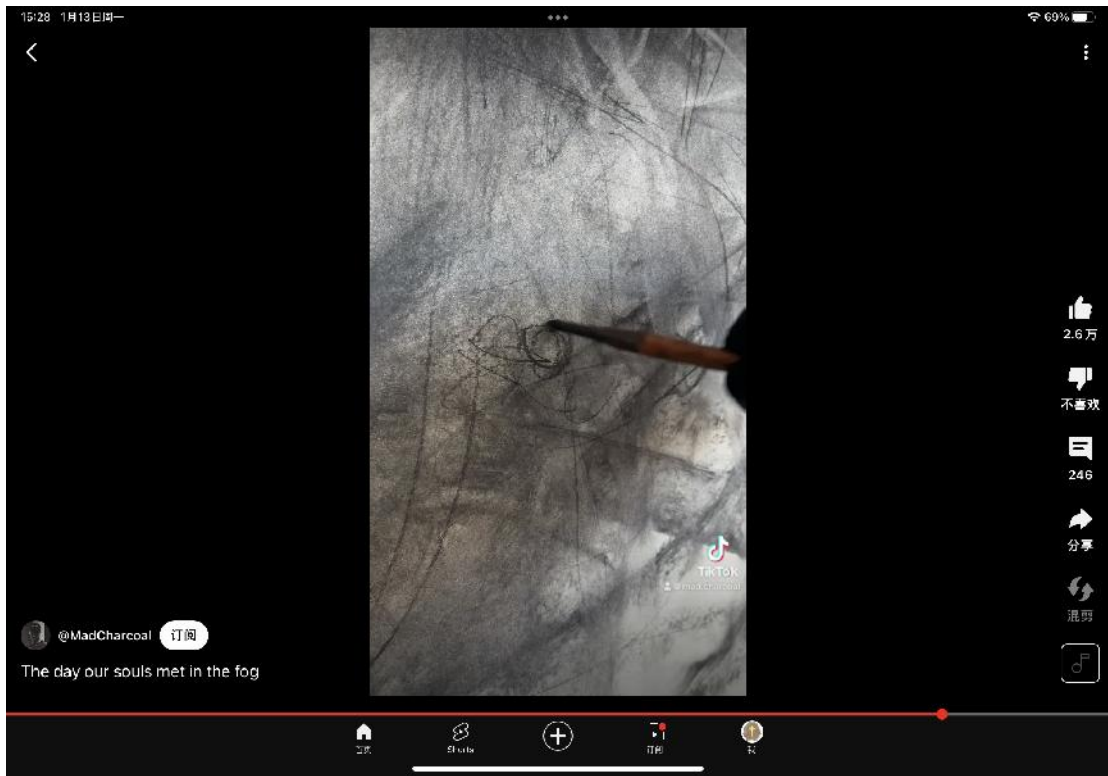

炭笔画

<https://youtube.com/shorts/lcGGh-VFX44?si=rjsRyY-083Q4M7Nj>

U2

改变地点 --- 哈克尼帝国剧院

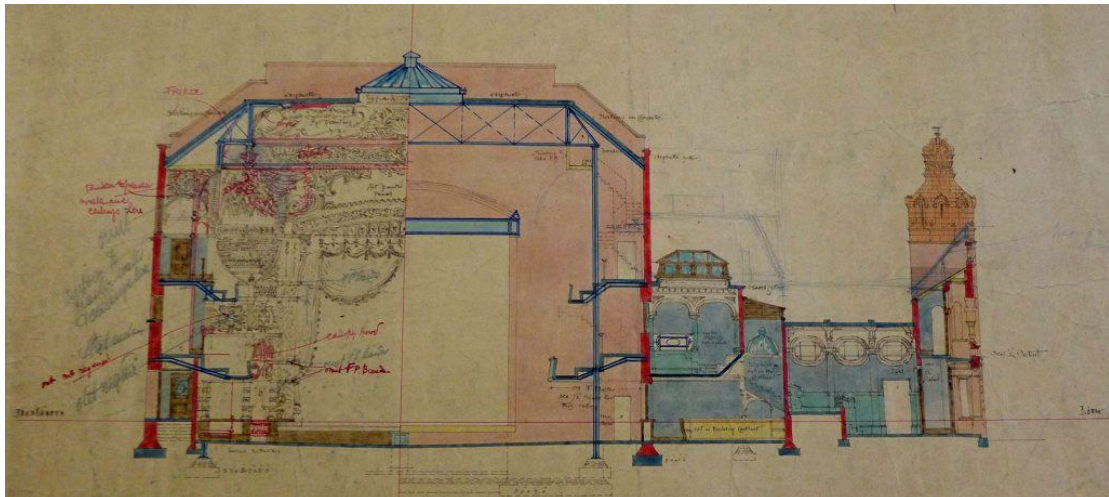

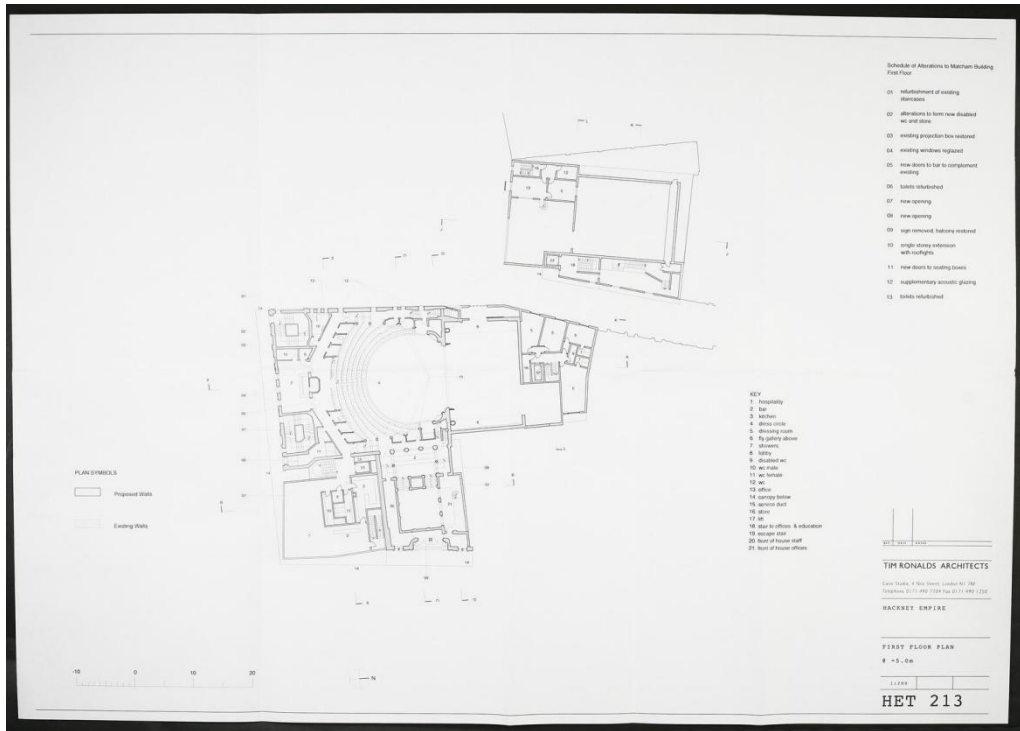

免费参观的时间太靠后了，我还是去看个表演

这个剧院票价以外的便宜

我去的时候前面做了满满的学生，应该是个很亲民的剧院

HACKNEY EMPIRE

Romeo and Juliet
A Hackney Empire, Belgrade Theatre and Bristol Old Vic co-production
Wed 23/04/25 2:00PM
Stalls LL 2
This seat is planted at a right angle
£15.00 / Standard Price A
Order 25-TD-V999-QIN

Thank you for booking with Hackney Empire. This is your E-ticket.
You will be asked to show this ticket on entry to the theatre, either printed or on your mobile phone. Please have it open and ready to be scanned.

Which entrance do I need?
Entrance to Upper Circle and Gallery: Wilson Way
Step-Free Entrance to LIT: Wilson Way

We have a bar on every level.
Please do come and join us when doors open and during the interval! Please note that we are now cashless and will only be accepting card payments, although we do not accept American Express. There are a number of restaurants in close proximity to Hackney Central.

Assistive Listening System available, please visit hackneyempire.co.uk/ access for more information or ask a member of Staff during your visit.

Ticket terms and conditions:
(1) The management reserves the right to refuse admission and to take any appropriate action to enforce this right. (2) The management reserves the right to alter or amend the programme as necessary as a result of unforeseen circumstances. (3) Latecomers may be refused admission. (4) The management reserves the right to refuse entry of and use on the premises of any camera or any form of audio-visual recording equipment.

Hackney Central, Hackney Downs
Bethnal Green, Hackney Town Hall

BECOME A FRIEND OF HACKNEY EMPIRE
From £5 a month or £60 a year

Keep us at the heart of our community
hackneyempire.co.uk/friends

<https://www.hackneyempire.co.uk/>

The visit time is too late. I'd better go and watch a performance

This theatre is cheaper than the ticket prices

When I went there, the front was full of students.

It should be a very approachable theatre

巴塞罗那 高迪之家
Gaudi House in Barcelona

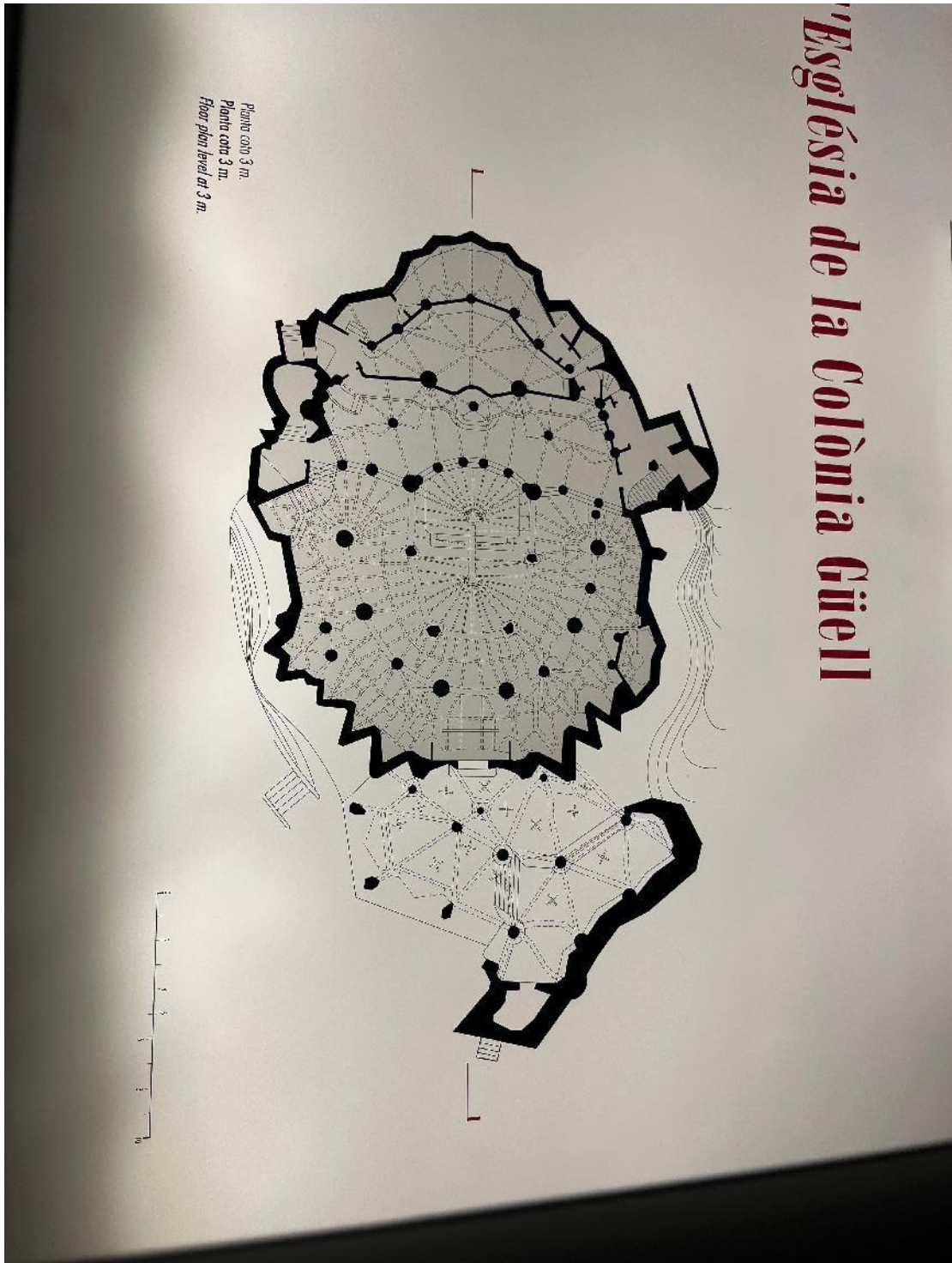

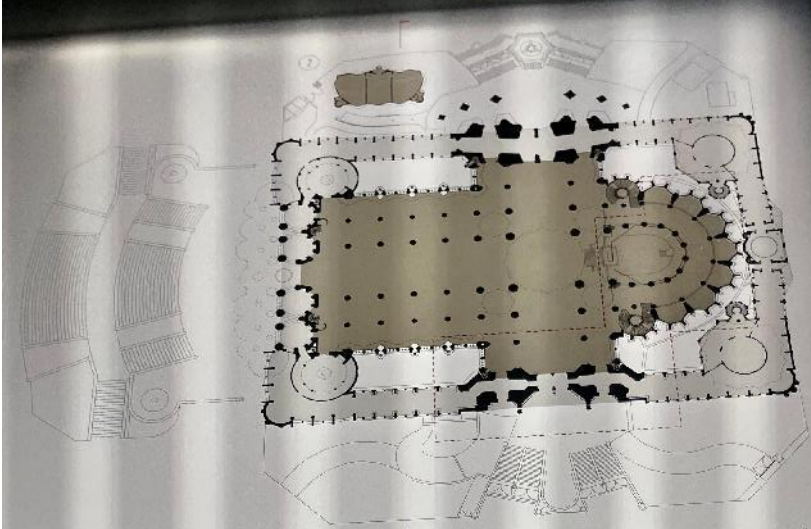

Pianta col. S.M.
Pianta col. S.M.
Floor plan level of 5 m.

CONTR. di 1924
CONTR. di 1921
Aut. 1920

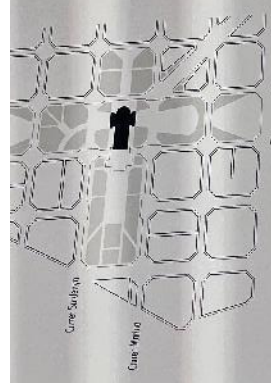

Cappella S. Sabino
Cappella S. Maria

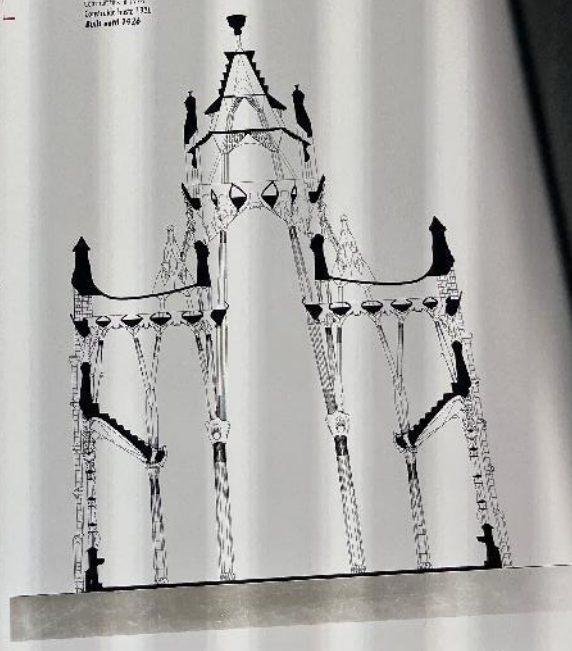



戏剧般的建筑效果
采用邻区所产的花岗岩，以垂直线形所设计的外形使得主教宫与雄伟的阿斯托加大教堂相比毫不逊色。

非圆形结构
非圆形结构为这个以军事象征意义及其建筑元素作为其设计方向的非整体建筑规划上第一具有宗教性的建筑元素。

3 窗
在窗的外部可以看到格罗夫的三个窗框，位于南、东和西塔楼中。

自然主义
窗框及许多建筑顶部结构的装饰，采用自然主义风格，而非以植物样式及图案装饰。

3:2:2 窗框长宽高之间的比例
在其原设计当中，建筑窗框高度所对应的长度、宽、高的比例，长度测量的计算为从门楣到窗框的总长度。

1890
这一年高迪完成了圣佩德罗入口门廊的建造。

入口大门
可以看到帽子和贝壳的浮雕装饰，这是主教纹章的元素。

南塔

东塔

拱顶石

支撑结构

空间和自然永远没有界限。

在非洲远古部落的语言里，时间和空间是一个词。

Space and nature never have boundaries.

In the languages of ancient African tribes, time and space were one word.

大卫艾克 地球史上最震撼的访谈：来自非洲的 科瑞多穆特瓦 - 蜥蜴人传说的起源

The most shocking interview in Earth's history by David Eyck: The Origin of the Legend of the Lizard Man from Coredo Mutwa, Africa

bilibilihttps://www.bilibili.com/video/BV1TuYbeKEGe/?spm_id_from=333.1387.favlist.content.click&vd_source=96a45ec95a1c686fe6ac29d82f616037

然而，不可思议的是，那些我一直坚信的、却又看似古怪荒谬的故事情节，虽然仅仅是从一个有条件的视角观察到的事实真相，可是，在我开始与科瑞多·穆特瓦进行访谈时，凭借他在非洲的生活经验，以及掌握大量丰富知识的阅历，他居然详尽地讲述了一个同样的故事，也正是我在世界范围内搜索详细资料进行调查后的结论。

非洲和全世界正在寻求自由人们，而我们是自由的，那么，一定要听一听他说了什么...

他们一定要听...就是现在。我将以科瑞多是怎样获得他想要分享的知识的叙述，作为访谈的开始。

他将第一次与我们分享许多事例，尽管这些知识只有部落的“传授者”才有资格获取，可正如科瑞多说的那样，“全世界需要知道这些！”所以，这是一部很非同寻常的视频访谈，

而且这绝对是一位非同寻常的人。正如我说过的，我事先请求他，从他获得非洲渊博知识的缘由开始谈起...

However, incredibly, those storylines that I had always firmly believed in but seemed strange and absurd, although merely the truth observed from a conditional perspective, when I began to work with Coredo. When Mutwa was being interviewed, relying on his life experience in Africa and his extensive knowledge, he actually told the same story in detail, which was exactly the conclusion I reached after searching for detailed information and conducting investigations worldwide.

Africa and the whole world are seeking free people, and we should be free. So, be sure to listen to what he has said...

They must listen... Right now. I will start the interview with a account of how Coredo acquired the knowledge he wanted to share. He will share many examples with us for the first time. Although only the "transmitters" of the tribe are qualified to obtain this knowledge, as Coredo said, "The whole world needs to know this!" So, this is a very extraordinary video interview. And this is definitely an extraordinary person. As I said, I asked him in advance to start with the reasons why he acquired profound knowledge of Africa...



荣格 集体潜意识

Jung's collective subconscious

https://www.youtube.com/watch?v=C5cuKwNjiUs&t=494s&ab_channel=Eternalised



各国神话传说故事讲解 9 集

Explanations of myths and legends from various countries in 9 episodes

Chinese mythology

Japanese mythology

Sumerian mythology

Egyptian mythology

Norse Mythology

Indian mythology

Greek mythology

告诉相似的世界观 体系 这是集体潜意识吗？还是说确有其事？

Tell similar worldview systems: Is this the collective subconscious? Or is it true?

https://www.bilibili.com/video/BV1ZR4y1m7HB?spm_id_from=333.788.videopod.sections&vd_source=96a45ec95a1c686fe6ac29d82f616037

八大文明奇迹现在就剩一个金字塔了，如果金字塔也没有的话。是不是就要叫八大文明传说了？古时候的神话故事是口口相传的。在没有纸笔发明出来之前，没有语言发明之前，人们靠画画来传达信息。

所以壁画值得更多保护和研究。

Among the eight wonders of civilization, there is only one pyramid left now, if there is no pyramid either. Is it going to be called the Legend of the Eight Great Civilizations? Mythological stories in ancient times were passed down orally. Before the invention of pen and paper and before the invention of language, people conveyed information by drawing.

So murals deserve more protection and research.

Why you prefer to go to theatre not cinema?

FRAGMENTED TONGUE THEATRE

CONCEPT

The architectural language is minimal, the audience is situated within a bare white space, listening to "fragmented lines" from different cultures through headphones. There is no physical theatre, only sound, scent, and coloured light creating a spectral sense of culture-experience.

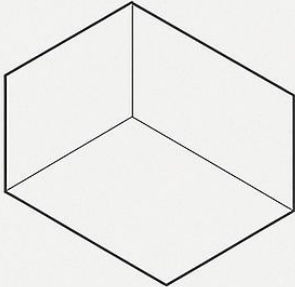

BARE WHITE SPACE

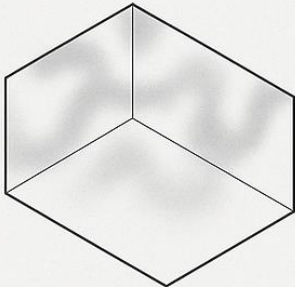

COLOURED LIGHT



SPATIAL ANALYSIS



HEADPHONE LISTENING

已经有人做过类似的了，内容不同但形式很像

Someone has already done something similar. The content is different but the form is very similar



I was video chatting with a friend, but the network was lagging

和朋友视频，但是网络卡了

My friend said that she would lose her voice halfway through my speech, which reminded her that we had gone to the theatre to watch a performance together before.

朋友说听我说话说到一半就没声音了，让她想起来之前我们一起去剧院看表演。

Because it was the first time to go to that theatre and the two of us arrived at different times and our seats were not adjacent, we didn't go in together.

因为是第一次去那个剧院而且两个人到达的时间不一样，位置也不挨着，就没一起进去。

After entering, the network was very poor. The two of them felt as if the network had crashed and couldn't hear each other.

结果进去之后网络又很差，俩人就像这个网络卡掉了一样听不到彼此。

It feels quite interesting. These two things can also be connected.

感觉还挺有趣的，这两件事情也可以连接起来。

可以把宇宙剧院和耳语的经历结合起来，我觉得这个思路不错。目前这样。

The experience of the Cosmic Theatre and the Whisper can be combined. I think this idea is good.
It is like this for now.

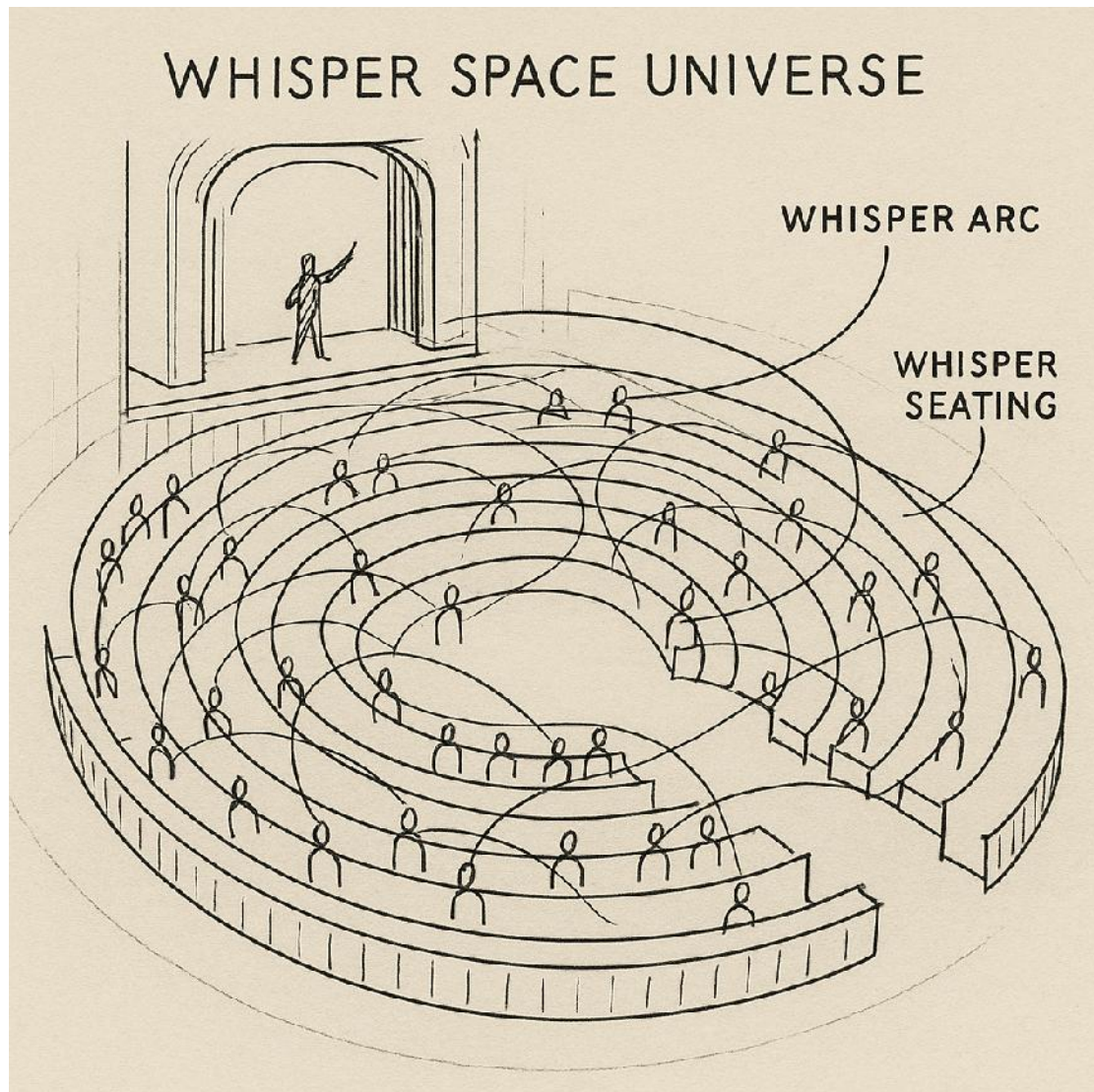

图片来自于 GPT

The image is from GPT

那么耳语的轨迹是怎样的？

So, what is the trajectory of the whisper?

它们是不是像银河一样环绕舞台？

Do they circle the stage like a silvered galaxy?

我去过的所有剧院都有着古老且辉煌的感觉

Every theatre I've entered feels ancient, resplendent—

所以我希望耳语的轨迹是金灿灿的
so I dream the traces of whispers are golden,

像秋天的果实 也像宇宙的银河
like autumn fruit,
like the Milky Way itself.

回声流动在剧院之中
Echoes drift through the theatre,

沉静在历史的故事中
resting softly in the hush of history,

说悄悄话
speaking only in whispers.

形式探索（电影）：
Form Exploration (Film):



[YouTube 15 film 1920 1080 EN](#)

黑白默片，我认为这种形式更加贴近我的主题

Black and white silent films, I think this form is closer to my theme

很有庄重和历史感

It has a strong sense of solemnity and history



A Trip to the Moon (Le Voyage dans la Lune) is a 1902 French adventure film directed by Georges Méliès.

这种黑白片子的感觉 是我想要应用在我的电影里的氛围

This black-and-white film feel is the atmosphere I want to apply in my movie

———— Go to my movie *Assimilated echo* .