

Bedroom set plan



The first step in creating my sets was drawing plans at 1:25 scale.

Street plan

Some sets changed a lot from the initial plan, but it was still useful to have a design sketched out as a guide for what to build.

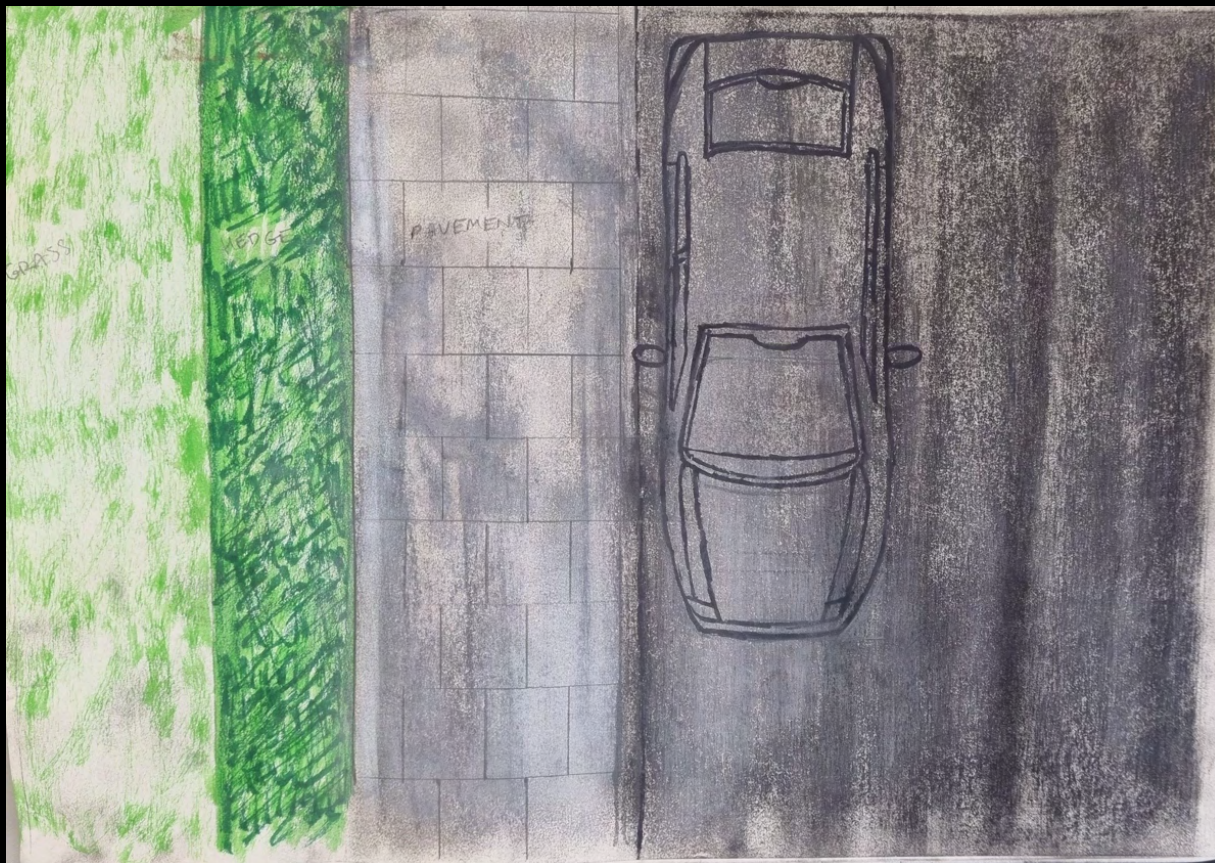

Later street elevation



When it was time to build this set, I drew out an updated elevation to work to.

Train platform plan & elevation

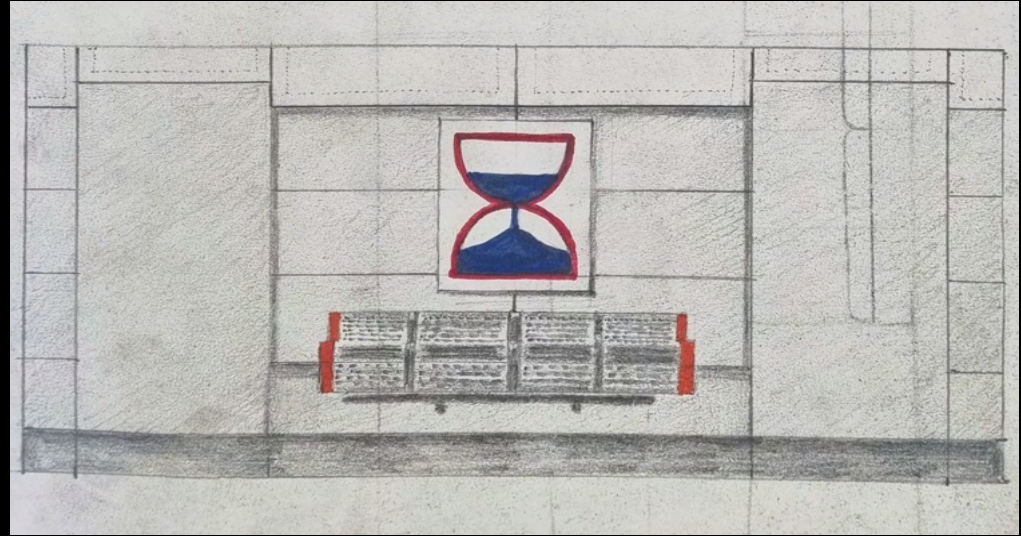
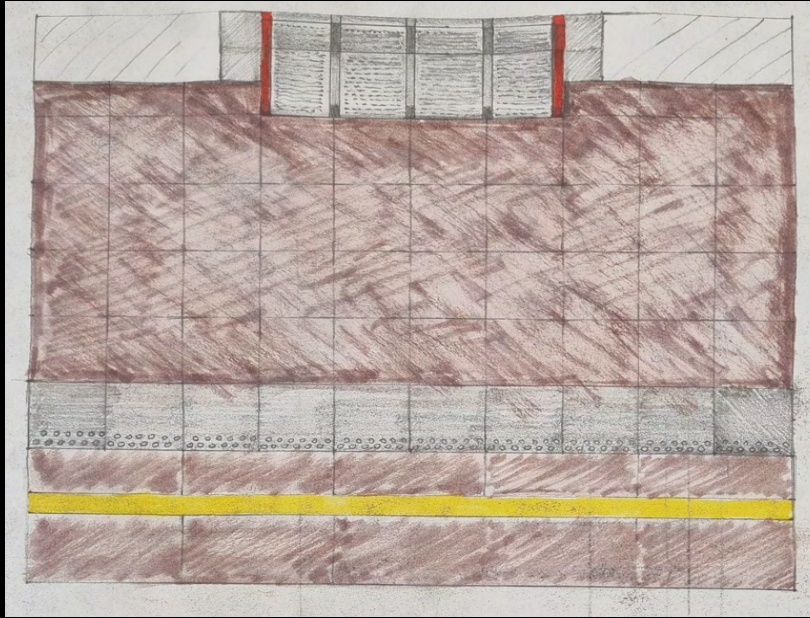

Train carriage plan & elevation

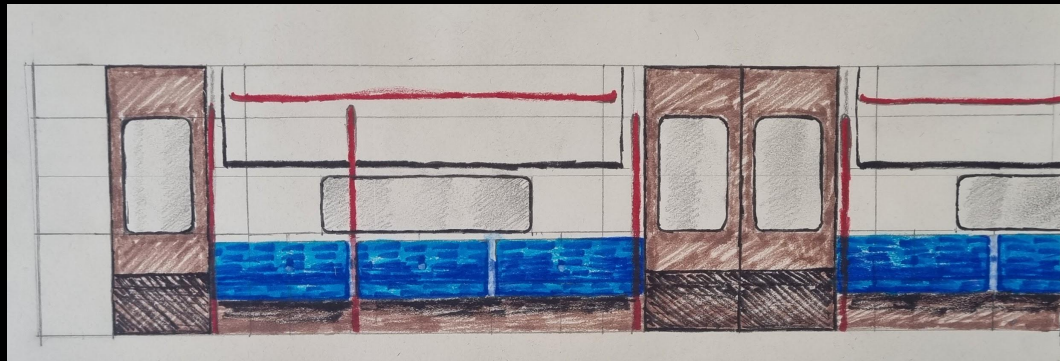
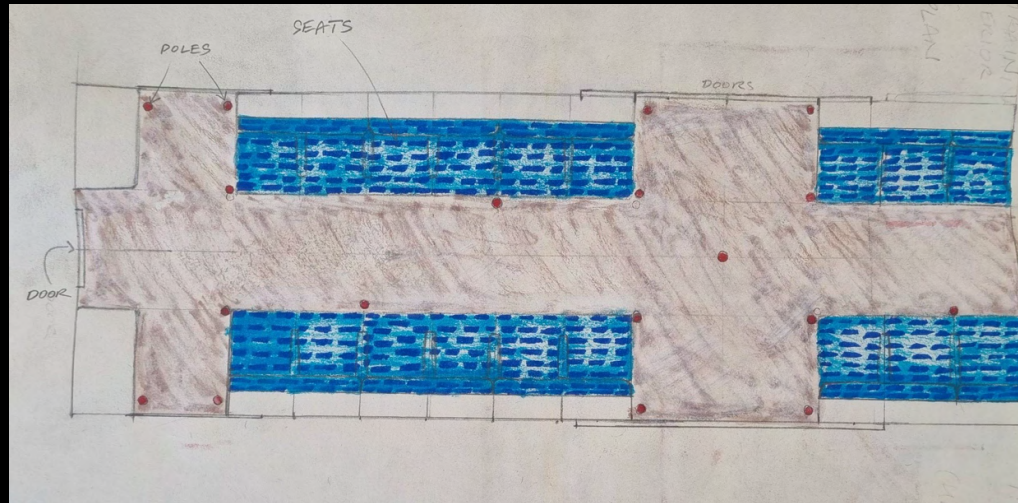

Bus interior plan & elevation

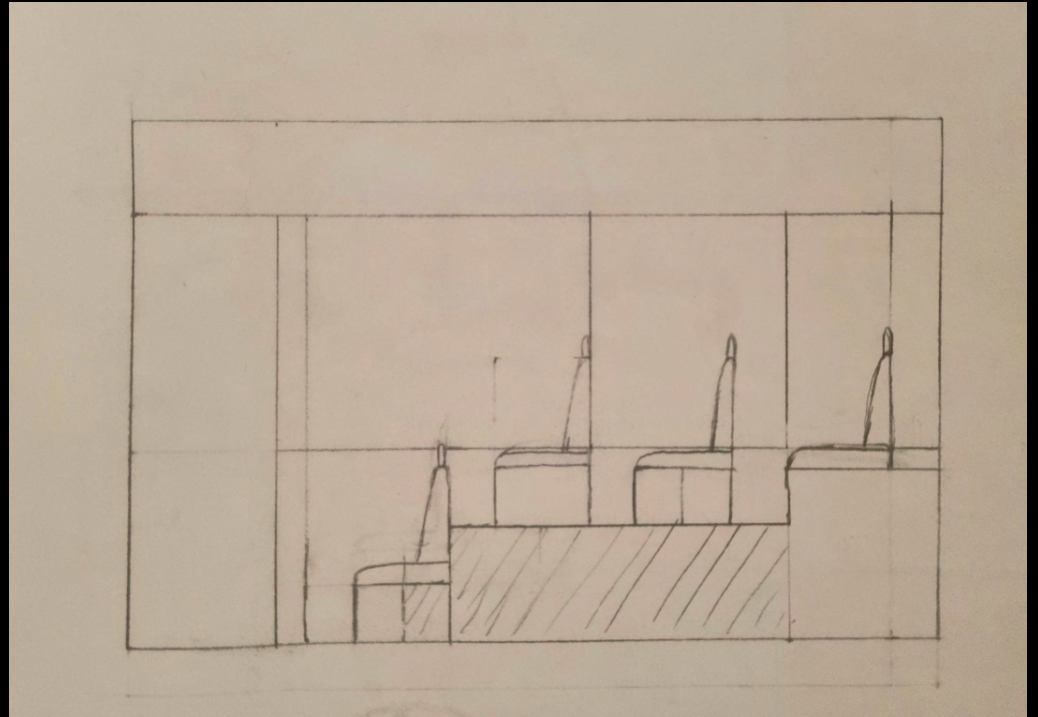
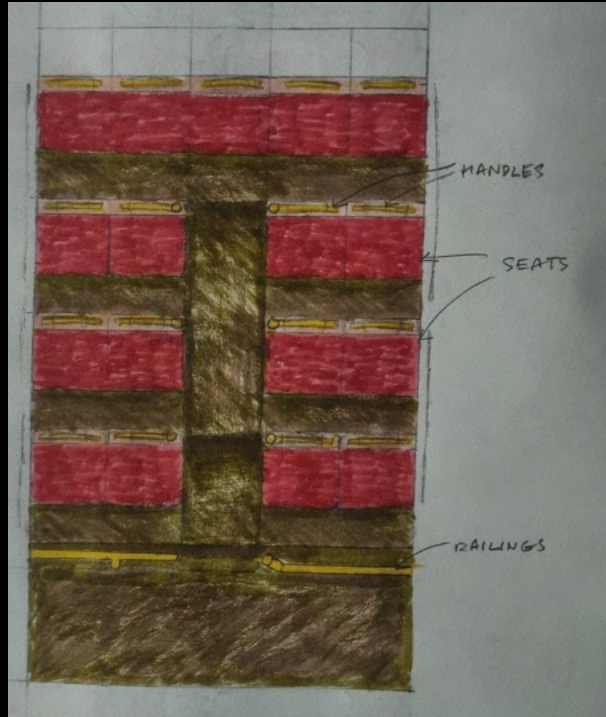

Elevator plan & elevation

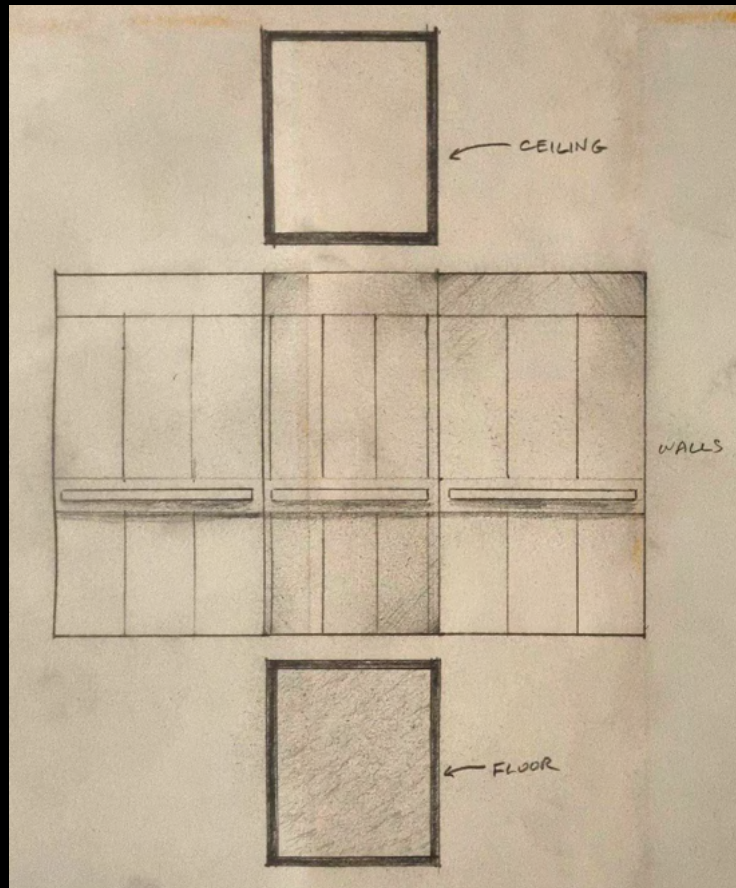

Corridor initial plan & elevation

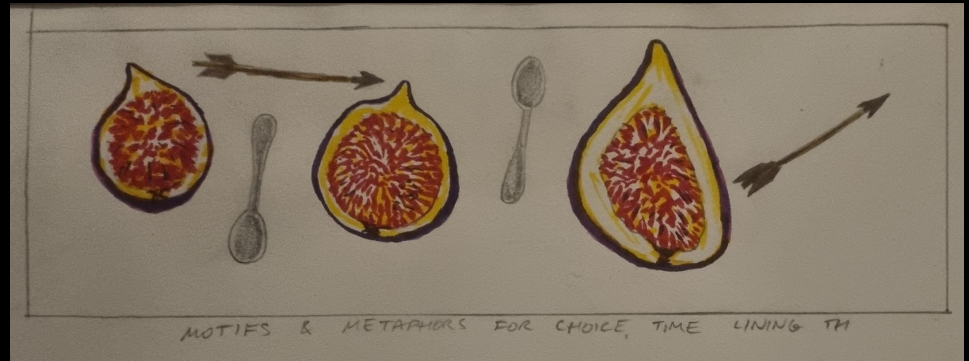
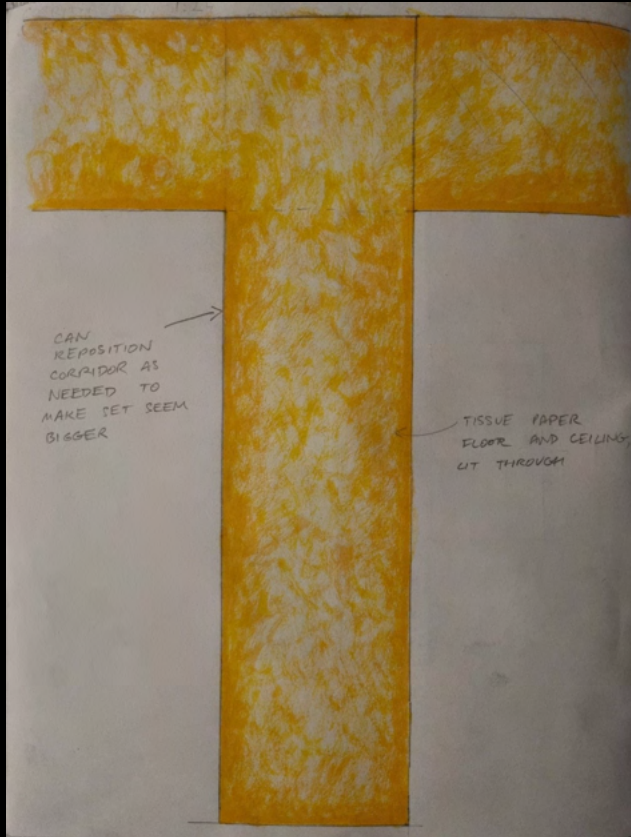

This changed the most as I knew it would be the last set to construct and I had not fully developed the design at this stage.